

# GS1 LED Series

## GeoScapes1 LED Wall Sconce



Type:	Job:							Approvals:
Catalog Number:								
Ordering Example: GS108UTBK0546KH2								
<div><div>GS1</div><div></div><div></div><div></div><div></div><div></div><div></div><div></div><div></div></div>								Date: Page 1 of 3
Series	Driver	Voltage	Finish	LED#	Color Temp.	Optics	Options	

Overall Dimensions *for reference only*

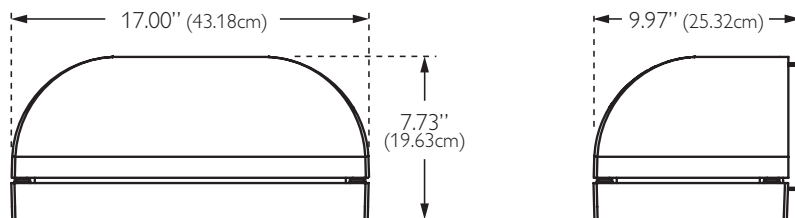

Weight: 28 lbs 12.7 kgs

## Specifications

### Applications

Ideal for Schools, Malls, Office Buildings, Industrial Parks, Hospitals, Sports Complexes, and Commercial Centers. Functions in environments with temperatures that range from -30°C to 40°C.

### Rated Life

60,000 hours.

### Ambient

Functions in environments with temperatures that range from -30°C to 40°C.

### Construction

Heavy duty die cast aluminum housing. Integral cast aluminum heat sink. Fully tempered soda lime glass lens.

### Electrical

Electronic class II LED driver accepts 120-277v, 50/60hz input (constant current). 054 LED consumes 95 watts (08 Driver). 054 LED consumes 70 watts (06 Driver). 049 LED consumes 102 watts (08 Driver). 049 LED consumes 72 watts (06 Driver).

### LED Optical System

High-output LEDs. Individual precision optics collect and redirect light to optimize performance. LED optical system individually controls the placement of light in the target area, minimizing glare. LEDs have an average rated life of 60,000 hours (L70).

### Mounting

Pre-mountable wall box with integral splice chamber. (No J-Box needed). Built-in bubble level for accuracy. Hands-free fixture to wall positioning for easy wiring.

### Finish

Polyester powder coating, 2.5 mil nominal thickness, electrostatically applied and oven cured to ensure extreme durability.

<b>TBK</b>	Textured Black
<b>TWHT</b>	Textured White
<b>TDB</b>	Textured Dark Bronze
<b>TSA</b>	Textured Satin Aluminum
<b>TGR</b>	Textured Gray
<b>TGN</b>	Textured Green

Custom RAL colors may be specified.

### Listings

UL/cUL 1598 listed, suitable for Wet Locations. The quality systems of this facility have been registered by UL to the ISO 9001 Series Standards.

### Warranty

Standard 5 Year Limited Warranty. The current Philips Wide-Lite Warranty may be found at [www.wide-lite.com](http://www.wide-lite.com) (keyword: warranty) as well as the current Standard Terms and Conditions of Sale (keyword: terms).

*All sales of items in this catalogue shall be subject to the Philips Wide-Lite Standard Terms and Conditions of Sale current at the time of shipment. If you do not have a copy of the Philips Wide-Lite Warranty and Standard Terms, please contact the factory for same prior to ordering.*

# GS1 LED Series

## GeoScapes1 LED Wall Sconce

Type:	Job:	Page 2 of 3
-------	------	-------------

GeoScapes 1 LED  
GS1



**Ordering Example:** GS108UTBK0546KH2

Series	Driver	Voltage	Finish	Board	Options		
				LED #	Color Temp.	Optics	
<input checked="" type="checkbox"/> <b>GS1</b>	<input type="checkbox"/> <b>08</b> <input type="checkbox"/> <b>06'</b>	<input type="checkbox"/> <b>U</b> 120-277	<input type="checkbox"/> <b>TSA</b> Textured Satin Aluminum <input type="checkbox"/> <b>TDB</b> Textured Dark Bronze <input type="checkbox"/> <b>TBK</b> Textured Black <input type="checkbox"/> <b>TWHT</b> Textured White <input type="checkbox"/> <b>TGR</b> Textured Gray <input type="checkbox"/> <b>TGN</b> Textured Green <input type="checkbox"/> <b>RAL(*)</b> Custom Color (*=specify finish)	<input type="checkbox"/> <b>054</b> <input type="checkbox"/> <b>049</b>	<input type="checkbox"/> <b>6K</b> 054 LED Board only <input type="checkbox"/> <b>4K</b> 049 LED Board only	<input type="checkbox"/> <b>H2</b> Type II <input type="checkbox"/> <b>H3</b> Type III	<input type="checkbox"/> <b>PCB<sup>2</sup></b> Photocell Button (specify voltage)

Notes:  
1) 06 Driver is reduced wattage.  
2) Voltage must be specified as 120, 208, 240, 277V.

Accessories (must be ordered separately)

- ☐ **SC(F)** Surface Collar  
Surface collar for conduit.  
(F) = specify finish

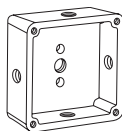

Philips Wide-Lite Professional Luminaires reserves the right to change specifications and dimensions without notice. Lamp and electrical specifications / availability subject to change by manufacturer without notice. Please refer to detailed specification sheets for additional information and spec details.

1611 Clovis Barker Road • San Marcos, TX 78666 • Phone: 512.392.5821 • Fax: 512.753.1122 • [www.wide-lite.com](http://www.wide-lite.com)

© 2012 Philips Group. All rights reserved.

Bulletin No. WLSP0346C0912

**PHILIPS**  
**WideLite**

# GS1 LED Series

## GeoScapes1 LED Wall Sconce

Type:	Job:	Page 3 of 3
-------	------	-------------

### Photometric Data

#### H2 Type II

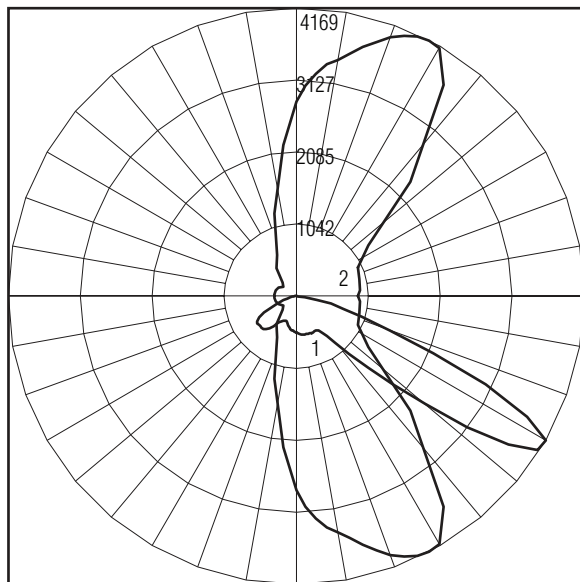

**Geoscapes Architectural Wallpack Led - Type II (H2)**  
**With Individual Led Lens Optics And Clear Flat Glass Lens**  
**54 White Leds. Lumen Output = 4170 Lms.**

#### Characteristics

IES Classification	Type II
Longitudinal Classification	Short
Cutoff Classification (deprecated)	Full Cutoff
Total Rated Lamp Lumens	4170
Maximum Candela	4169
Maximum Candela Angle	62.5H 60V
Maximum Candela At 90 Degrees Vertical	0 (0.0% Lamp Lms)
Maximum Candela from 80 to <90 Degrees Vertical	361 (8.7% Lamp Lms)
Downward Total Efficiency	100.9%
Total Luminaire Watts	87
Ballast Factor	1.00

#### H3 Type III

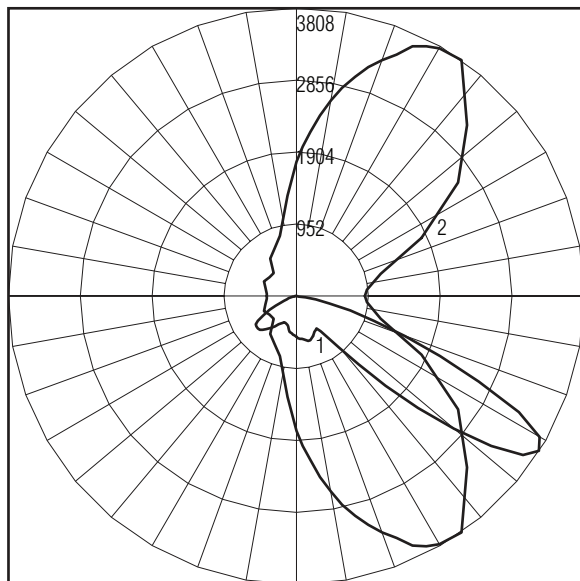

**Geoscapes Architectural Wallpack Led - Type III (H3)**  
**With Individual Led Lens Optics And Clear Flat Glass Lens**  
**54 White Leds. Lumen Output = 4199 Lms.**

#### Characteristics

IES Classification	Type III
Longitudinal Classification	Short
Cutoff Classification (deprecated)	Full Cutoff
Total Rated Lamp Lumens	4199
Maximum Candela	3808
Maximum Candela Angle	55H 57.5V
Maximum Candela At 90 Degrees Vertical	0 (0.0% Lamp Lms)
Maximum Candela from 80 to <90 Degrees Vertical	337 (8.0% Lamp Lms)
Downward Total Efficiency	100.1%
Total Luminaire Watts	87
Ballast Factor	1.00



ISO 9001  
Certified



Philips Wide-Lite Professional Luminaires reserves the right to change specifications and dimensions without notice. Lamp and electrical specifications / availability subject to change by manufacturer without notice. Please refer to detailed specification sheets for additional information and spec details.

1611 Clovis Barker Road • San Marcos, TX 78666 • Phone: 512.392.5821 • Fax: 512.753.1122 • [www.wide-lite.com](http://www.wide-lite.com)

© 2012 Philips Group. All rights reserved.

Bulletin No. WLSP0346C0912

**PHILIPS**  
**WideLite**